

# CERTIFICATE OF LOCATION OF GOVERNMENT CORNER

**East Quarter** Corner of Section **3** , Township **108** , Range **41** 5th P.M.  
STATE OF MINNESOTA, County of Murray.

**Statement:** Aug. 30, 1989 - Found a brass plug in the 1932 Concrete road pavement surface. The brass plug is noted by the Highway Department to be above a field stone.



## SKETCH OF REFERENCE TIES

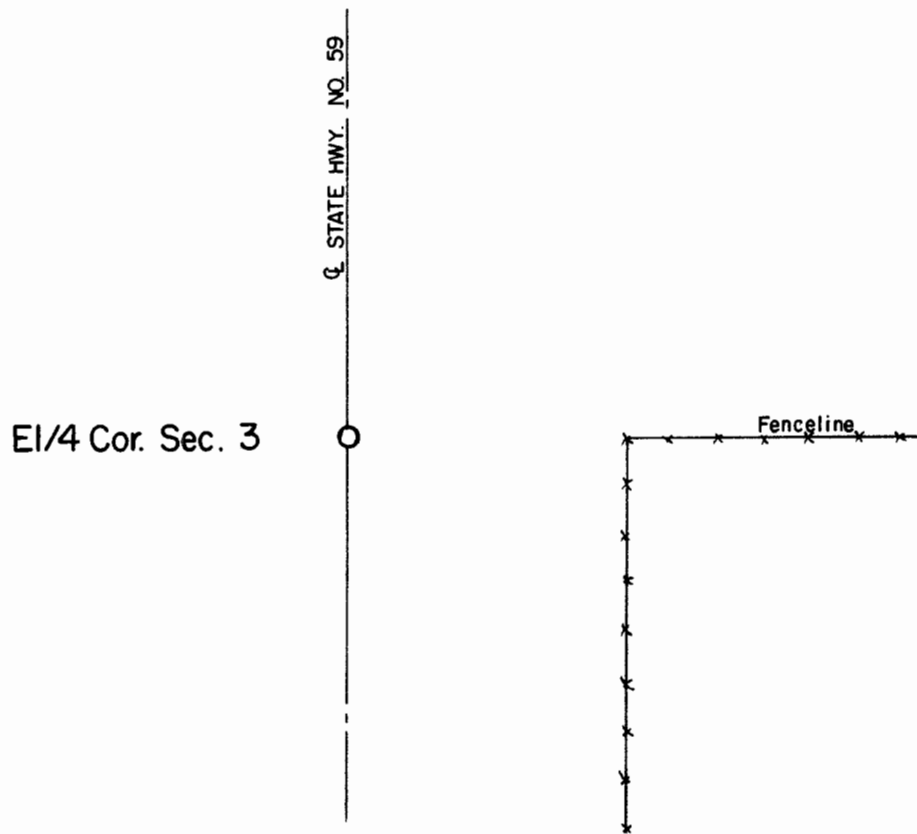

Statement of evidence relative to this corner location is on the back of page.

I hereby certify that this document and the data contained herein was prepared by me or under my direct supervision and that I am a duly Registered Land Surveyor under the laws of the State of Minnesota.

  
Duane A. Bonnema

Nov 6, 1989  
Date

Minnesota Registration No. 14895

OFFICE OF THE COUNTY RECORDER  
COUNTY OF MURRAY **NOV 15 1989**

I hereby certify that this document was filed in the County Recorder's office at \_\_\_ M. on the \_\_\_ day of \_\_\_\_\_ A.D., 19\_\_

County Recorder

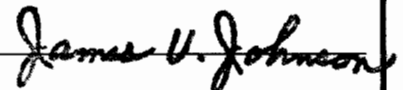

By \_\_\_\_\_, Deputy

DOCUMENT NO. \_\_\_\_\_

East Quarter Cor. Sec. 3 T108N-R41W

Statement:

- September 1861 Original Government Land Office Surveyor L. G. M. Fletcher records in his field notes, "Set post in mound with trench pits and a charred stake per instruction."
- Aug. 22, 1899 J. W. Woolstencroft, County Surveyor, records in the County Surveyor's Record Book, page 90 "Oak Stake 2 inches x 2 inches x 24 inches" while doing survey work in Section 3.
- 1931 The Minnesota Department of Transportation records in their field notes of State Trunk Highway 59, "1/4 Corner on the Centerline - B. plug in place - field stone in place."
- Aug.30, 1989 Duane A. Bonnema, L.S. 14895, removed 4 inches of asphalt which exposed the old concrete road surface at a point 50 feet west of an aluminum capped iron monument marked "Trunk Highway Right of Way, Sta 749+31.5, CL 50 ft." A 3/4 inch brass plug was found which had been drilled into the old concrete pavement surface by the Minnesota Department of Transportation in 1931. At that time, the Highway Department recorded that they placed the brass plug over the field stone. Further digging is severely hampered by the old concrete road which contains an abundance of steel reinforcing rod. It appears that the brass rod is the best available evidence of the quarter corner location.